



**10th Annual Research Society on
Marijuana Scientific Conference**

July 17-19, 2026

Hotel Albuquerque

Albuquerque, New Mexico, USA

Who are we?

The Research Society on Marijuana (RSMj) is a network of scientists with the shared goal of promoting understanding through empirical research of the determinants, correlates, consequences, contexts, and assessment of marijuana use as well as the treatment of problematic marijuana use, including cannabis use disorder.



RSMj Guiding Principles

1. We are first and foremost a research society. Thus, we are guided by research in the marijuana field, not by any personal or political agenda.
2. We are a nonprofit organization. We will not be influenced by the profit motive. There are other organizations that may be sympathetic to our mission, but to maintain objectivity, we will not accept sponsorship from any for-profit or political advocacy group.
3. We are a society concerned with improving human adversity. Therefore, we focus most of our attention on furthering research that has immediate benefit to reduce human suffering or improve human well-being.

RSMj Board of Directors (in alphabetical order):

Adrian J. Bravo (President)
Bradley T. Conner (Conference Program Chair, Past President)
Robert D. Dvorak (Board Member)
Kyra Farrelly (Student Representative)
Reagan Fitzke (Student Representative)
Verlin Joseph (Secretary-Treasurer)
Benjamin O. Ladd (Vice President)
Lauren Micalizzi (Board Member)
Jane Metrik (Board Member, Incoming President)
Matthew R. Pearson (Board Member, Past President)
Eric R. Pedersen (*Cannabis* Editor)
Mohammad Habib (Student Representative)
Yan Wang (Board Member)
Jeffrey D. Wardell (Board Member)

Program Committee:

Bradley T. Conner, Ph.D.,
Conference Program Committee Chair, RSMj Executive Board Member

Jeffrey D. Wardell, Ph.D.,
Conference Program Committee Member, Submissions Team Co-Lead

Jamie E. Parnes, Ph.D.,
Conference Program Committee Member, Submissions Team Co-Lead

Lauren Micalizzi, Ph.D.,
Conference Program Committee Member, Submissions Team Member

Holly Boyle, Ph.D.,
Conference Program Committee Member, Submissions Team Member

Sophie G. Coelho, M.A.
Conference Program Committee, Trainee Program Committee Member, Submissions Team Member

Mohammad Habib, M.A.
Conference Program Committee, Trainee Program Committee Member, Submissions Team Member

Stephanie Penta, M.A.
Conference Program Committee, Trainee Program Committee Member, Submissions Team Member

Special thanks to Nicole Dimitrova, who helped to prepare the conference program document; Reagan Fitzke who helped with organizing, planning and the website, and provided support during the conference; Kyra Farrelly who helped with organizing and provided support during the conference; and Ireland Shute who provided support during the conference.

Hotel Albuquerque Meeting Space

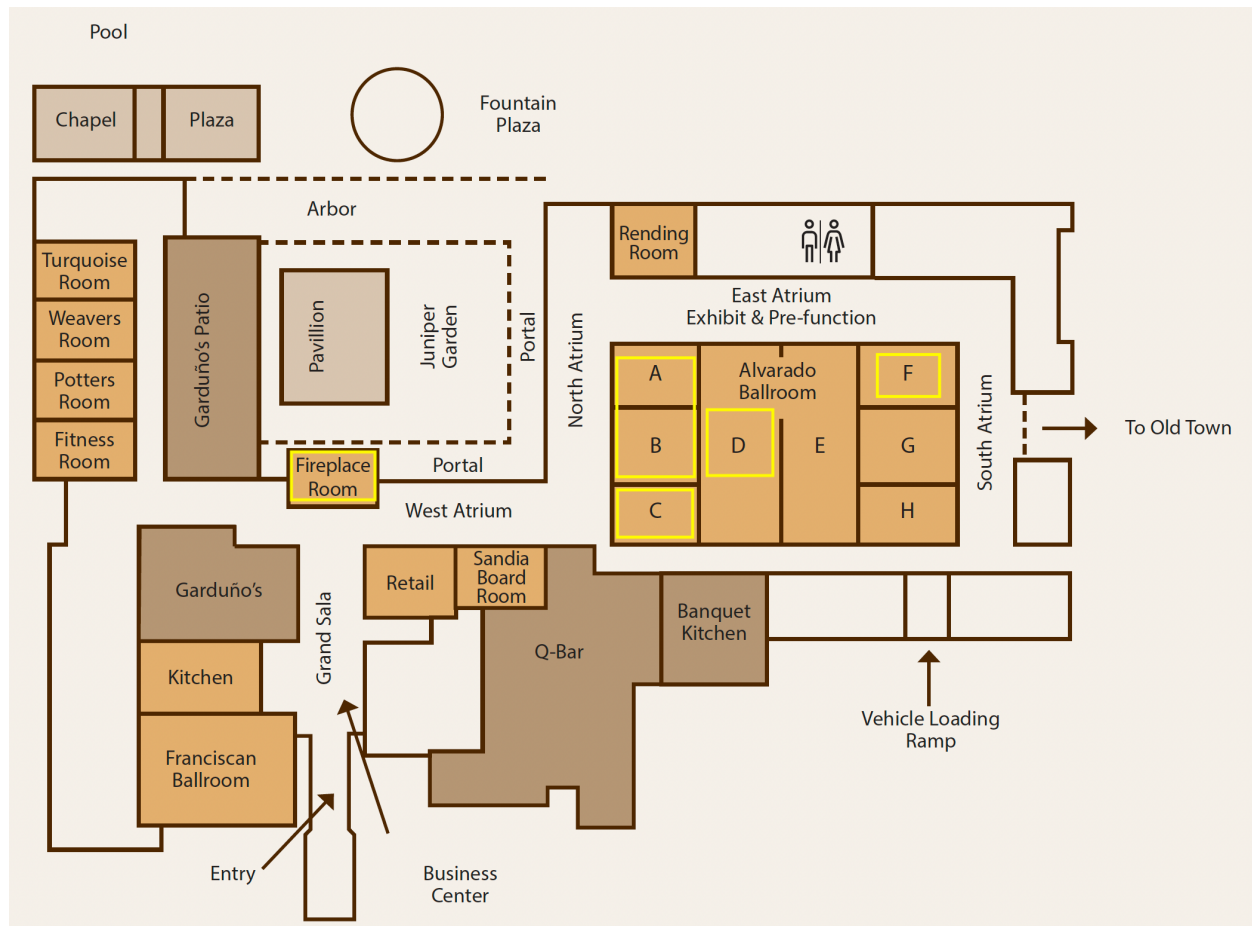

Our program will be offered in the **Alvarado** Ballroom/Breakout Rooms with:

Keynotes Alvarado D
 Symposia in Alvarado D and F
 Paper Sessions in Alvarado C
 Posters in Alvarado A/B

Breakfast and Coffee in Alvarado A/B (8-9am Daily)

Registration and Badge Pick Up in the Atrium outside of Alvarado

Food/Beverage Information:

Continental Breakfast with Breakfast Burritos provided Friday and Saturday morning
 Continental Breakfast provided on Sunday morning
 Coffee and Soft Drinks provided 1-5 p.m. on Friday and Saturday
 An Afternoon Snack provided at the Poster Sessions Friday and Saturday

Info for Students and Trainees

The RSMj Trainee Program Committee invites all trainees (undergraduate, postbacc, graduate, postdoctoral, etc.) to join the official conference Discord for trainees! This platform can be used to meet other trainee attendees in advance of and during the conference and connect about travel and lodging arrangements, meeting up while in Albuquerque, research collaborations, resources, and more.

To join the discord, please follow the link or scan the QR code below:

<https://discord.gg/U6FKfs3GYp>

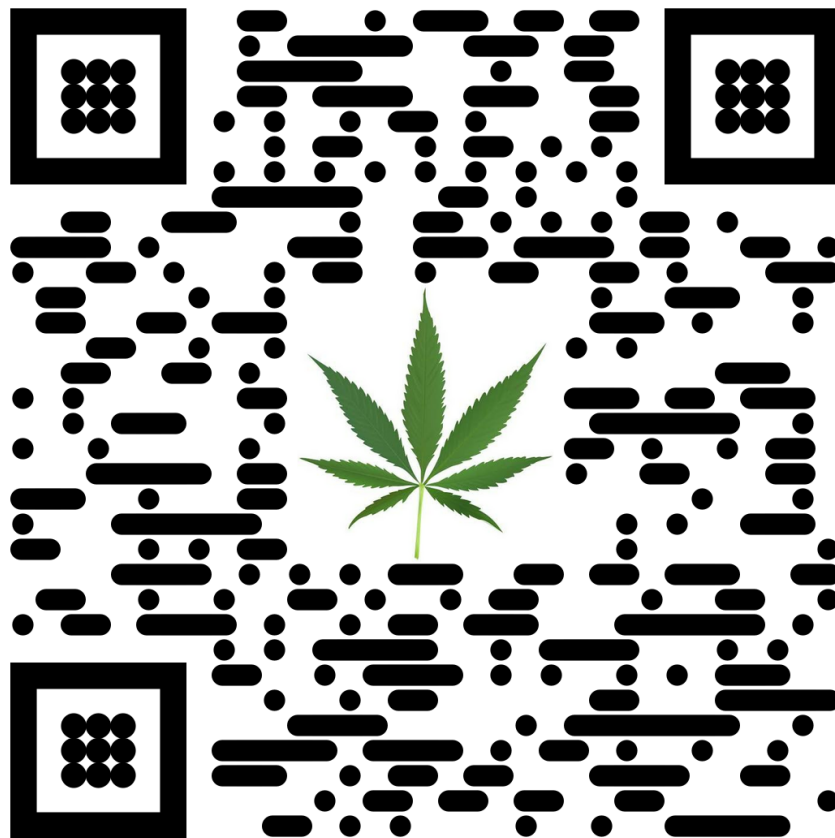

We look forward to connecting with you and hope to see you in Albuquerque!

CONGATULATIONS TO OUR 2026 STUDENT AWARD WINNERS!

Student Research Award Winners:

Motives for Use, Background Mood, and Experienced Mood Effects of Cannabis Use Among Young Adults

Veronica M. Bucci (University of Illinois Chicago)

Risk Perceptions and Motives for Cannabis and Derived Intoxicating Cannabis Products: A Cross-Sectional Survey in a Non-Probability Sample of Co-Using U.S. Adults

Dan Petrovitch (Texas Tech University; University of Texas Health Science Center at Houston)

Cannabinoid Molar Metabolite Ratios are Superior to THC in Predicting Subjective Intoxication

Claire L. Pince (University of Colorado Boulder)

Underrepresented Student Award Winners:

Exploring Associations between Cannabis Use and Suicidality in Emerging Adults: A Scoping Review

Nathan Meredith (Western Kentucky University)

Perspectives on Cannabis Among Native American Patients Seeking Pain Management

Sara Mills (Washington State University)

Cannabis use changes self-reported stress among college students with Cannabis Use Disorder: An ecological momentary assessment

Cassandra Richardson (Colorado State University)

Honorable Mentions:

Evaluating the Accuracy of Cannabis Quantity Estimations

Mohammad I. Habib (Colorado State University)

Characterizing Cannabis Use Among Recently Trauma-Exposed Emergency Department Patients

Gillian Rossmann (Brown University; Rhode Island Hospital)

Cannabis and Psilocybin Co-Use: Associations with Stress and Well-Being

Alexia Obrochta (Oregon State University)

Please join us for the Student Award Winner Flash Talk Session on Friday at 1:30 where a selection of the award winners will present their research in a Flash Talk. See page 22 for a list of speakers.

THURSDAY JULY 16, 2026

Pre-Conference Social Event
Fireplace Room next to Hotel Lobby Bar
Hotel Albuquerque (Conference Hotel)
(Badge Pick Up, Cash Food and Bar)

5:00 PM – 8:00 PM

FRIDAY JULY 17, 2026

Alvarado D

Alvarado F

Alvarado C

8:00 AM – 5:00 PM

Conference Registration and Badge Pick Up, Outside Alvarado

Poster Session 1
 Setup Throughout
 the Day in
 Alvarado AB

8:00 AM – 9:00 AM

Continental Breakfast and Coffee Service, Outside Alvarado

9:00 AM – 9:15 AM

Opening Remarks

--

--

9:15 AM – 10:30 AM

Keynote Address:
 Mathew R. Pearson

10:30 AM – 10:45 AM

Break

10:45 AM – 12:00 PM

Symposium: Warning about
 Cannabis Liking and Wanting:
 Linking Subjective Effects from
 Acute Response to Longitudinal
 Risk

Chair:
 Jane Metrik

Presenters:
 Claire L. Pince
 Yi-Chun Chang
 Jack T. Waddell
 Sharla Kirkpatrick

Symposium: Cannabis in Context:
 Polysubstance Use Profiles, Mental
 Health, and Social Determinants
 Among Adolescents

Chair:
 Verlin Joseph

Presenters:
 Verlin Joseph
 Eunice Kim
 Lillian Walker
 Esperanza D Wells

Paper Session: Cannabis
 Interventions and Therapeutics

Chair:
 Reagan Fitzke

Alison Giovanelli - Incentivized
 Potency Reduction and Genetic
 Polymorphism in Young Adult
 Users of High Potency Products

Kayla Balabanis - Cannabis Quit
 Rates Among Dual Users
 Contacting a State Tobacco
 Quitline

		<p>Discussant: Verlin Joseph</p>	<p>Daniel R. Trigo (Bradley T. Conner presenting) - Material Hardship and Intention as Moderators of Cannabis Co-use to Reduce Opioid Use, Withdrawal, and Withdrawal-related Pain Among Community Recruited People Who Inject Drugs in Los Angeles, CA and Denver, CO</p> <p>Samantha N. Melendez - Longitudinal Edible Cannabinoid Use, Pain Disability, and Prescription Medication Use Among Individuals with Chronic Low Back Pain</p>	
12:00 PM – 1:30 PM	Break for Lunch (on your own)			
1:30 PM – 2:45 PM	<p style="text-align: center;"><u>Symposium:</u> <u>Advancing Evidence-Based Interventions for Cannabis Use Through Novel Approaches</u></p> <p style="text-align: center;">Chair: Kristina T. Phillips</p> <p style="text-align: center;">Presenters: Kristina T. Phillips Jenni B. Teeters Kathryn S. Gex</p>	<p style="text-align: center;"><u>Student Award Ceremony and Flash Talks</u> <u>(Trainee Program Committee)</u></p> <p style="text-align: center;">Chair: Stephanie Penta</p> <p style="text-align: center;">Award Winners: Veronica M. Bucci* Nathan Meredith* Sara Mills Dan Petrovitch Claire L. Pince Cassandra Richardson*</p> <p style="text-align: center;">Honorable Mentions: Mohammad I. Habib* Alexia Obrochta* Gillian Rossmann*</p> <p style="text-align: center;"><i>Asterisk (*) denotes honorees who will present a flash talk of their posters during the session.</i></p>	<p style="text-align: center;"><u>Paper Session: Cannabis Policy/Regulation/Marketing #1</u></p> <p style="text-align: center;">Chair: Holly K. Boyle</p> <p>Allison M. Glasser - Prevalence of Past 12-Month Blunt Use Among Young Adults in the United States by Cannabis Policy Exposure, 2013 to 2023</p> <p>Holly K. Boyle - THC-Infused Beverages: Awareness, Perceptions, and Use Among Young Adults Who Drink Alcohol</p> <p>Annie Mullin - Confiscated Cannabis Products from U.S. Schools, 2021-2025: Product Types and Brand Trends</p>	

2:45 PM – 3:00 PM	Break			
3:00 PM – 4:15 PM	<p><u>Symposium: Contemporary Challenges in Cannabis Research: Understanding Perceptions, Evaluating Harm Reduction, and Quantifying Use</u></p> <p>Chair: Matthew R. Pearson</p> <p>Presenters: Renee E. Magnan Chloe E. Martinez Mason L. Hatwan</p> <p>Discussant: Matthew R. Pearson</p>	<p><u>Symposium: Cannabis Use Across the Lifespan: Epidemiology, Cognitive Vulnerability, and Brain-Behavior Function</u></p> <p>Chair: Godfrey D. Pearlson</p> <p>Presenters: Anika M. Guha Ashley Schnakenberg-Martin Lauren Pacek Shashwath A. Meda</p> <p>Discussant: Godfrey D. Pearlson</p>	<p><u>Paper Session: Highlighting the Research in the Cannabis Special Issue on Perinatal Cannabis Use</u></p> <p>Chairs: Eric Pedersen, Lauren Micalizzi, Rachel Gunn</p> <p>Presenters: Rachel L. Gunn Lauren Micalizzi Kelly C. Young-Wolff Marie A. Hayes Lindy K. Howe</p>	
4:15 PM – 5:15 PM	--	--	--	Poster Session I in Alvarado AB (light snack provided)
6:30 PM – 11:00 PM	<p>Social Event – All Attendees Welcome Outpost 1706 Bar, 301 Romero St NW Suite 205, Albuquerque, NM 87104 Appetizers Provided, Cash Bar</p>			

SATURDAY JULY 18, 2026

Room:	Alvarado D	Alvarado F	Alvarado C	
8:00 AM – 5:00 PM	Conference Registration and Badge Pick Up, Outside Alvarado			Poster Session 2 Setup Throughout the Day in Alvarado AB
8:00 AM – 9:00 AM	Continental Breakfast and Coffee Service, Outside Alvarado			
8:00 AM – 9:00 AM	<p align="center">Trainee Mentorship Breakfast - All Students/Postdocs/Trainees Welcome Location – Alvarado AB (poster room)</p> <p align="center"><u>Participating Mentors:</u> Kalina Fahey, Rachel Gunn, Cassidy LoParco, Godfrey Pearlson, Jamie Parnes, Charlie Villanueva</p>			
9:00 AM – 10:15 AM	Keynote Address: Adrian J. Bravo	--	--	
10:15 AM – 10:30 AM	Break			
10:30 AM – 11:45 AM	<p align="center"><u>Symposium:</u> <u>Understanding Adolescent and Adult Cannabis Co-use with Alcohol and/or Nicotine: Integrating Experimental and EMA Findings</u></p> <p align="center">Chair: Holly K. Boyle</p> <p align="center">Presenters: Rachel N. Cassidy Lindy K. Howe Holly K. Boyle Rachel L. Gunn</p>	<p align="center"><u>Symposium:</u> <u>Exploring the Link Between Mental Health and Cannabis Use and Co-use in Young Adults: With Considerations for Clinical Practice</u></p> <p align="center">Chair: Kyra Farrelly & Reagan Fitzke</p> <p align="center">Presenters: Stephanie M. Penta Kyra N. Farrelly Reagan E. Fitzke Brenna A. Carter</p> <p align="center">Discussant: Adrian J. Bravo</p>	<p align="center"><u>Paper Session: Neuroscience and Biomarker Research</u></p> <p align="center">Chair: Ireland Shute</p> <p>Sarah A. Thomas - The Role of Subcortical Brain Tissue Iron as an Indicator of Dopamine-Related Neurophysiology in Adolescent Cannabis Use</p> <p>Leslie Brick - Cannabis Use is Associated with Blunted Cortisol Stress Reactivity in Individuals with Early Life Stress and Anxiety and Trauma Disorders</p> <p>Emma E. Smith - Detecting Cannabis Intoxication Using Wearable Biosensors and Machine Learning: A Pilot Study</p>	

11:45 AM – 1:15 PM	Break for Lunch (on your own)			
1:15 PM – 2:30 PM	<p style="text-align: center;"><u>Symposium: Weeding Through the Complexities of the Cannabis Continuum</u></p> <p style="text-align: center;">Chair: Elizabeth R. Aston</p> <p style="text-align: center;">Presenters: Elizabeth R. Aston Kirstyn N. Smith-LeCavalier Alexander W. Sokolovsky Lauren Micalizzi</p> <p style="text-align: center;">Discussant: Hayley Treloar Padovano</p>	<p style="text-align: center;"><u>Symposium: 'Weed Work Well Together': State Approaches to Cannabis Research and Regulation, Collaboration is Key</u></p> <p style="text-align: center;">Chair: Hailey Pensky</p> <p style="text-align: center;">Presenters: Kaitlin Kosinski Alexandria Wilkins Graelyn Humiston Maryland Office of Social Equity</p> <p style="text-align: center;">Discussant: Hailey Pensky</p>	<p style="text-align: center;"><u>Paper Session: Cannabis Policy/Regulation/Marketing #2</u></p> <p style="text-align: center;">Chair: Stephanie Penta</p> <p>Cassidy R. LoParco - Recall of Cannabis Advertising Messages and Warnings among US Young Adults: An Experimental Study</p> <p>Emma J. Therkildsen - Health Halo and Horn Effects on Cannabis Edible Packaging</p> <p>Sarah D. Kowitt (Leah M. Ranney presenting) - Characteristics of Cannabis Warnings in the United States: A Content Analysis</p> <p>Leah M. Ranney - Inside the Regulatory Process of Developing and Implementing Cannabis Product Warnings: A Qualitative Study</p>	
2:30 PM – 2:45 PM	Break			
2:45 PM – 4:00 PM	<p style="text-align: center;"><u>Symposium: The PBSM 10 Years Later: Advancing Cannabis Protective Behavioral Strategy Measurement Across Populations and into the Modern Cannabis Landscape</u></p> <p style="text-align: center;">Chair: Eric R. Pedersen</p>	<p style="text-align: center;"><u>Panel Discussion: Driving Human Subjects Research in a State of Change: Measurement, Recruitment, and Ethical Lessons Learned in a Cannabis and Open-Road Driving Performance Protocol</u></p> <p style="text-align: center;">Chair: Nicole Ennis</p>	<p style="text-align: center;"><u>Paper Session: Community and Patient-Oriented Research</u></p> <p style="text-align: center;">Chair: Kyra Farrelly</p> <p>Matt Reid - Are You an Asshole for Smoking? Cannabis Norms Related to Neighbor Disputes, Public Use, and Narcing</p>	

	<p>Presenters: Keegan D. Buch Kristina T. Phillips Mark A. Prince</p>	<p>Presenters: Nicole Ennis Katie Kloss Sara Green</p>	<p>Joanna S. Zeiger - Patient-Reported Patterns of Cannabis Consumption and Subjective Effects in Rheumatic and Musculoskeletal Diseases</p> <p>Darcey McCready - Cannabis Use Among US Young Adult Cancer Survivors: Impacts of Legal Context, Information Sources, and Interactions with Healthcare Providers</p> <p>Sara Mills - Perspectives on Cannabis Among Native American Patients Seeking Pain Management</p>	
--	--	---	--	--

4:00 PM – 5:00 PM	--	--	--	Poster Session 2 in Alvarado AB (light snack provided)
-------------------	----	----	----	--

SUNDAY JULY 19, 2026

Room:	Alvarado D			
--------------	-------------------	--	--	--

8:00 AM – 12:00 PM Conference Registration and Badge Pick Up, Outside Alvarado

8:00 AM – 9:00 AM Continental Breakfast and Coffee Service, Outside Alvarado

9:00 AM – 10:15 AM	<p><u>Symposium: Derived Intoxicating Cannabis Products: An Overview of Retail, Marketing, Perceptions, and Use Behaviors</u></p> <p>Chair: Dan Petrovitch</p> <p>Presenters: Cassidy R. LoParco Julia Chen-Sankey</p>	--	--	--
--------------------	--	----	----	----

	Dan Petrovitch Darcey McCready			
	Discussant: Dan Petrovitch			
10:15 AM – 10:30 AM	Break			
	<u>Paper Session: Cannabis Policy/Regulation/Marketing #3</u>			
	Chair: Mohammad Habib			
	Christina Zakala (Patricia Di Ciano presenting) - Driving by Frequent Cannabis Users 'The Morning After' Last Use of Smoked Cannabis: Relationship to THC			
10:30 AM – 11:45 AM	Julia Chen-Sankey - Understanding How Leading Cannabis Brands Use 'Natural,' 'Clean,' 'Pure,' and 'Organic' Claims in Their Marketing	--	--	--
	David B. Buller - Association Between Neighborhood Deprivation, Distance, and Compliance with a State Ban on Sales to Apparently Alcohol-Intoxicated Customers by Adult-Use Cannabis and Alcohol Retailers			
	Mengni Jing - Association between legal access to cannabis and rates of suicide mortality among adults in the United States from 2012 to 2023			
11:45 AM – 12:00 PM	Concluding Remarks: Jane Metrik	--	--	--

Friday, JULY 17, 2026

8:00 am – 5:00 pm

Check-In/Registration

Outside Alvarado

8:00 am – 9:00 am

Continental Breakfast

Outside Alvarado

9:00 am – 9:05 am

Conference Opening/Introduction

Alvarado D

9:05 am – 9:15 am

Opening Remarks

Alvarado D

Adrian J. Bravo, President of RSMj (*William & Mary*)

9:15 am – 10:30 am

Keynote Address

Alvarado D

RSMj Origins and MATEO RANTs

Matthew R. Pearson (University of New Mexico)



Dr. Matthew R. Pearson (aka Mateo) is a Research Professor at the University of New Mexico's Center on Alcohol, Substance use, And Addictions (CASAA). Trained as an experimental psychologist, he is broadly interested in substance-related harm reduction. As the director of the Mechanisms of Addiction Treatment and Ecological Observations (MATEO) laboratory, much of his grant-funded research has used ecological momentary assessment (EMA) to test the efficacy and psychological mechanisms of various interventions ranging from mindfulness-based interventions, cognitive retraining (e.g., attentional bias modification, working memory training), and a just-in-time adaptive intervention targeting alcohol protective behavioral strategies. His lab also uses EMA to explore mechanisms naturalistically when experimental approaches are not ethical or practical like the mechanisms mobilized by mutual help group involvement (i.e., Alcoholics Anonymous). He served as the coordinating PI of several multi-site studies focused on substance use among college students including the Marijuana Outcomes Study Team (2015-2017), Protective Strategies Study Team (2017), and the Addictions Research Team (2020-present). He is the Founding President of the Research Society on Marijuana (RSMj). He is an accomplished substance use researcher and an unaccomplished comedian (and yes, he insisted on this part being included in this bio).

10:30 am – 10:45 am

Break

Friday, JULY 17, 2026

10:45 am – 12:00 pm

Symposium

Alvarado D

Warning about Cannabis Liking and Wanting: Linking Subjective Effects from Acute Response to Longitudinal Risk

Chair: **Jane Metrik** (Brown University)

Subjective drug effects are central to addiction theory, particularly within the incentive salience framework, which distinguishes between dimensions of 'liking' (hedonic reward) and 'wanting' (motivational drive). While laboratory research has established that Δ -9-THC reliably produces dose-dependent increases in subjective intoxication and positive affect (e.g., euphoria), negative responses (e.g., anxiety) often emerge at higher doses or among less frequent users. However, the influence of specific individual characteristics, biological markers, and event-level variables on these experiences remains poorly understood. The symposium elucidates these acute and longitudinal determinants by synthesizing findings across laboratory, observational, and intensive longitudinal designs. The series of four talks starts by demonstrating how novel approaches to quantifying cannabinoid biomarkers improve the precision of estimating subjective intoxication. The session further illustrates how subjective responses signal a heightened risk for problematic use across vulnerable populations: first, by showing how longitudinal increases in positive subjective effects and diminished sensitivity drive progression toward chronic use in adolescents; second, by demonstrating that acute craving serves as a potent motivator for continued use, particularly in social contexts for those with problematic use; and finally, by showing how individual differences in distress intolerance amplify acute subjective reinforcement. Collectively, these studies illustrate how subjective experiences relate to biological markers and are shaped by situational cues, developmental trajectories, and individual vulnerabilities that can escalate risk. Implications for evidence-based interventions targeting cannabis reinforcement alongside policy strategies to mitigate adverse effects and refine intoxication detection, are discussed.

PRESENTERS:

Cannabinoid Molar Metabolite Ratios are Superior to THC in Predicting Subjective Intoxication

Claire L. Pince (University of Colorado Boulder), **Megan E. Brown** (University of Colorado Boulder), **Carillon J. Skrzynski** (University of Colorado Boulder), **Marco O. Torres** (University of Colorado Boulder), **Angela D. Bryan** (University of Colorado Boulder), **Kent E. Hutchison** (University of Colorado Anschutz Medical Campus), **L. Cinnamon Bidwell** (University of Colorado Boulder)

Tolerance to Cannabis Subjective Effects with Cumulative Cannabis Use Experience During Adolescence

Yi-Chun Chang (University of Southern California Institute for Addiction Science), **Adam Leventhal** (University of Southern California Institute for Addiction Science)

Acute Cannabis Craving and Use Behavior in Daily Life: Contextual Influences and Variation by Use Severity

Jack T. Waddell (Arizona State University), **Michael Erickson** (Arizona State University), **Sarah A. Okey** (University of Washington), **Jane Metrik** (Brown University), **William R. Corbin** (Arizona State University)

Distress intolerance moderates subjective response to cannabis

Sharla Kirkpatrick (Brown University), **Rachel L. Gunn** (Brown University), **Elizabeth Aston** (Brown University), **Christopher Kahler** (Brown University), **Robert Swift** (Brown University), **Jane Metrik** (Brown University)

Mission

To leverage the highest standards of evidence-based research methodology to collectively advance the understanding of medicinal cannabis by curating the collective body of knowledge; advancing scientific discovery through innovative research projects; and, creating a network devoted to increasing the clinical understanding of the potential benefits and harms of cannabis.

Where to find us online



Budtalks.ca
Our knowledge translation initiative

















Find cannabis education opportunities

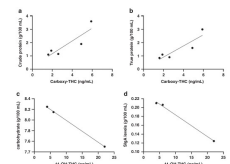

Explore our cannabis analytics platforms





Follow us on YouTube and LinkedIn





Subscribe to our monthly newsletter

For additional information including potential collaborations and studentship / fellowship opportunities please email Allan Fein at afein@mcmaster.ca

Friday, JULY 17, 2026

10:45 am – 12:00 pm

Symposium

Alvarado F

Cannabis in Context: Polysubstance Use Profiles, Mental Health, and Social Determinants Among Adolescents

Chair: **Verlin Joseph** (University of New Mexico)

Historically, cannabis use among adolescents has generally been investigated as an isolated substance use outcome. However, emerging evidence suggests cannabis use occurs among broader patterns of polysubstance use with distinct psychosocial risks and outcomes. Moreover, much of the existing literature relies on samples that are not fully representative of adolescent substance use patterns, limiting the ability to develop evidence-based interventions for adolescents experiencing elevated substance use risk. As such, this symposium will present findings derived from four empirical studies using data from the New Mexico Youth Risk and Resiliency Survey (YRRS) to examine cannabis-involved polysubstance use outcomes among adolescents. Using latent class analysis, we identified three distinct substance use profiles characterized by low use, moderate polysubstance use, and high polysubstance use. Across the studies presented in this symposium, we examine how these cannabis-involved polysubstance profiles relate to mental health outcomes, structural and social determinants of health, and protective psychosocial outcomes. Results indicate that adolescents in high-polysubstance use classes experience elevated risks of depression, anxiety, and suicidality. While structural adversity including homelessness, food insecurity, bullying, and unsafe school environments increase the likelihood of membership in high-risk substance use profiles. Conversely, protective resources such as strong parent relationships, school connectedness, engagement, and personal confidence are associated with lower odds of membership in cannabis-involved polysubstance classes. Together, these studies demonstrate that adolescent cannabis use is best understood within broader substance use ecosystems shaped by structural vulnerability and protective developmental assets.

PRESENTERS:

Cannabis-Involved Polysubstance Use Profiles Among Adolescents: A Latent Class Analysis

Verlin Joseph (University of New Mexico), **Lillian Walker** (University of New Mexico), **Esperanza D Wells** (University of New Mexico), **Eunice Kim** (University of New Mexico), **Michael G Miranda** (University of New Mexico), **Azizi Ray** (University of New Mexico), **Grace Chung** (University of New Mexico Health), **Laura B Nellums** (University of New Mexico)

Mental Health and Suicide Risk Across Cannabis-Involved Polysubstance Use Profiles

Eunice Kim (University of New Mexico), **Lillian Walker** (University of New Mexico), **Esperanza D Wells** (University of New Mexico), **Michael G Miranda** (University of New Mexico), **Azizi Ray** (University of New Mexico), **Grace Chung** (University of New Mexico), **Laura B Nellums** (University of New Mexico), **Verlin Joseph** (University of New Mexico)

Social Determinants of Cannabis-Involved Polysubstance Use Among Adolescents

Lillian Walker (University of New Mexico), **Eunice Kim** (University of New Mexico), **Esperanza D Wells** (University of New Mexico), **Michael G Miranda** (University of New Mexico), **Azizi Ray** (University of New Mexico), **Grace Chung** (University of New Mexico), **Laura B Nellums** (University of New Mexico), **Verlin Joseph** (University of New Mexico)

Protective Factors Associated with Lower Odds of Cannabis-Involved Polysubstance Use

Esperanza D Wells (University of New Mexico), **Eunice Kim** (University of New Mexico), **Lillian Walker** (University of New Mexico), **Michael G Miranda** (University of New Mexico), **Azizi Ray** (University of New Mexico), **Grace Chung** (University of New Mexico), **Laura B Nellums** (University of New Mexico), **Verlin Joseph** (University of New Mexico)

Discussant: **Verlin Joseph** (University of New Mexico)



Friday, JULY 17, 2026

10:45 am – 12:00 pm

Paper Session

Alvarado C

Cannabis Interventions and Therapeutics

Chair: **Reagan Fitzke** (University of New Mexico)

PRESENTERS:

Incentivized Potency Reduction and Genetic Polymorphism in Young Adult Users of High Potency Products

Alison Giovanelli (University of California), **Ari Kirshenbaum** (Advocates for Human Potential), **Veronika Mesheriakova** (University of California), **Louie Swander** (University of California), **Sara Zimmer** (Advocates for Human Potential), **Dustin Lee** (Johns Hopkins University), **Michael Sofis** (Advocates for Human Potential)

Cannabis Quit Rates Among Dual Users Contacting a State Tobacco Quitline

Kayla Balabanis (University of California), **Yue-Lin Zhuang** (University of California), **Jijiang Wang** (University of California), **Shu-Hong Zhu** (University of California)

Material Hardship and Intention as Moderators of Cannabis Co-use to Reduce Opioid Use, Withdrawal, and Withdrawal-related Pain Among Community Recruited People Who Inject Drugs in Los Angeles, CA and Denver, CO

Daniel R. Trigo (University of Southern California), **Sid S. Ganesh** (University of Southern California), **Srehith Sannareddy** (University of Southern California), **Bradley T. Conner** (Colorado State University), **Ricky N. Bluthenthal** (University of Southern California)

Longitudinal Edible Cannabinoid Use, Pain Disability, and Prescription Medication Use Among Individuals with Chronic Low Back Pain

Samantha N. Melendez (University of Colorado Boulder), **Renée Martin-Willett** (University of Colorado Boulder), **L. Cinnamon Bidwell** (University of Colorado Boulder)

12:00 pm – 1:30 pm

LUNCH ON YOUR OWN

Friday, JULY 17, 2026

1:30 pm – 2:45 pm

Symposium

Alvarado D

Advancing evidence-based interventions for cannabis use through novel approaches

Chair: **Kristina T. Phillips** (Permanente Hawaii; Kaiser Permanente Bernard J. Tyson School of Medicine)

Increased availability and reduced perceptions of harm related to cannabis have driven higher rates of cannabis use among adults in the U.S., underscoring a growing need for effective treatments and interventions. Although legal for adults in many U.S. states, cannabis use can lead to clinically significant impairment for many individuals, especially as product potency continues to rise. Young adults remain at heightened risk due to ongoing neurodevelopment and greater exposure to contexts where cannabis use is prevalent. These trends highlight the urgency of advancing evidence-based approaches to prevention and treatment. In this session, speakers will present cutting edge work spanning different samples, with a focus on innovative and novel approaches designed to meet the evolving public health challenges associated with increasing cannabis use. Kristina Phillips will open with an overview of the current science related to cannabis interventions, followed by a presentation focused on the design of a just-in-time adaptive intervention for young adults who use cannabis and alcohol who are enrolled in an ongoing clinical trial. Jenni Teeters will present findings from a recently completed randomized controlled trial evaluating a mobile brief intervention designed to reduce cannabis impaired driving among emerging adults. Kathryn Gex will discuss the acceptability of Computer-Based Training for Cognitive Behavioral Therapy (CBT4CBT) and its effects on cannabis use outcomes among adults with cannabis use disorder. Collectively, these three talks provide important insights into novel ways to address cannabis use in diverse populations.

PRESENTERS:

Understanding how and when to intervene: Examining the mechanics of a just-in-time adaptive intervention for cannabis and alcohol use

Kristina T. Phillips (Kaiser Permanente Hawaii; Kaiser Permanente Bernard J. Tyson School of Medicine), **Ho Suk Choi** (University of Hawai'i - Mānoa), **Mark A. Prince** (University of Southern California), **Michael M. Phillips** (University of Hawai'i - Mānoa)

Evaluation of an interactive mobile phone-based brief intervention to reduce driving under the influence of cannabis among emerging adults: A randomized controlled trial

Jenni B. Teeters (Western Kentucky University), **Alejandro B. Ramirez** (Western Kentucky University), **Nathan D. Meredith** (Western Kentucky University)

Exploring acceptability and cannabis use outcomes following CBT4CBT in adults seeking treatment for cannabis use disorder

Kathryn S. Gex (Medical University of South Carolina), **Kevin Branson** (Medical University of South Carolina), **Nathaniel Baker** (Medical University of South Carolina), **Aimee McRae-Clark** (Medical University of South Carolina), **Rachel L. Tomko** (Medical University of South Carolina)

Friday, JULY 17, 2026

1:30 pm – 2:45 pm

Award Winners and Honorable Mentions

Alvarado F

Flash Talks

Chairs: **Stephanie Penta**

Please join us for a session honoring our student award winners and honorable mentions. Please see page 6 of the program for full list of student award winners. Honorees will be congratulated and receive a certificate during the session. The session will also feature Flash Talks from students who received an award or honorable mention for their poster submission (see below for list of Flash Talk presenters). Students who received an award or honorable mention for an oral presentation will also be honored during the session, and information about their talk will be provided.

FLASH TALK SCHEDULE:

Motives for Use, Background Mood, and Experienced Mood Effects of Cannabis Use Among Young Adults

Veronica M. Bucci (University of Illinois Chicago)

Exploring Associations between Cannabis Use and Suicidality in Emerging Adults: A Scoping Review

Nathan Meredith (Western Kentucky University)

Cannabis Use Changes and Self-Reported Stress among College Students with Cannabis Use Disorder: An Ecological Momentary Assessment

Cassandra Richardson (Colorado State University)

Evaluating the Accuracy of Cannabis Quantity Estimations

Mohammad I. Habib (Colorado State University)

Characterizing Cannabis Use Among Recently Trauma-Exposed Emergency Department Patients

Gillian Rossmann (Brown University; Rhode Island Hospital)

Cannabis and Psilocybin Co-Use: Associations with Stress and Well-Being

Alexia Obrochta (Oregon State University)

AWARD WINNERS WITH TALKS IN OTHER SESSIONS:

Sara Mills (Washington State University)

-Presenting Friday at 3pm in Alvarado C

Dan Petrovitch (Texas Tech University; University of Texas Health Science Center at Houston)

-Presenting Sunday at 9am in Alvarado D

Claire L. Pince (University of Colorado Boulder)

-Presenting Friday at 10:45am in Alvarado D

Friday, JULY 17, 2026

1:30 pm – 2:45 pm

Paper Session

Alvarado C

Cannabis Policy/Regulation/Marketing #1

Chair: **Holly K. Boyle** (Yale University)

PRESENTERS:

Prevalence of Past 12-Month Blunt Use Among Young Adults in the United States by Cannabis Policy Exposure, 2013 to 2023

Allison M. Glasser (Rutgers Institute for Nicotine & Tobacco Studies), **Ce Shang** (The Ohio State University Wexner Medical Center), **David Hammond** (University of Waterloo), **Kymerle L. Sterling** (Rutgers Institute for Nicotine & Tobacco Studies), **Kevin R.J. Schroth** (Rutgers Institute for Nicotine & Tobacco Studies), **Andrea C. Villanti** (Rutgers Institute for Nicotine & Tobacco Studies)

Growing Up in the Hempire': Using ICPS Data to Contextualize Youth Novel Cannabinoid Use in Massachusetts

Alexander M. Colby (Cannabis Control Commission of Massachusetts), **Graelyn Humiston** (Cannabis Control Commission of Massachusetts), **Victoria Jean Louis** (Cannabis Control Commission of Massachusetts), **Julie K. Johnson** (Cannabis Control Commission of Massachusetts)

THC-Infused Beverages: Awareness, Perceptions, and Use Among Young Adults Who Drink Alcohol

Holly K. Boyle (Yale School of Medicine), **Madilyn Augustine** (Yale School of Medicine), **Oksana K. Ellison** (Yale School of Medicine), **Sahiti Kunchay** (Yale School of Medicine), **Stephanie S. O'Malley** (Yale School of Medicine), **Katie Witkiewitz** (University of New Mexico), **Kelly S. DeMartini** (Yale School of Medicine), **Lisa M. Fucito** (Yale School of Medicine)

Confiscated Cannabis Products from U.S. Schools, 2021-2025: Product Types and Brand Trends

Annie Mullin (Rutgers Institute for Nicotine & Tobacco Studies), **Eugene M Talbot** (Rutgers Institute for Nicotine & Tobacco Studies), **Kevin RJ Schroth** (Rutgers Institute for Nicotine & Tobacco Studies and Rutgers School of Public Health), **Cristine D Delnevo** (Rutgers Institute for Nicotine & Tobacco Studies and Rutgers School of Public Health), **Julia Chen-Sankey** (Rutgers Institute for Nicotine & Tobacco Studies and Rutgers School of Public Health), **Jessica K Jensen** (Rutgers Institute for Nicotine & Tobacco Studies and Rutgers Robert Wood Johnson Medical School)

2:45 pm – 3:00 pm

Break

Friday, JULY 17, 2026

3:00 pm – 4:15 pm

Symposium *Alvarado D*

Contemporary Challenges in Cannabis Research: Understanding Perceptions, Evaluating Harm Reduction, and Quantifying Use

Chair: **Matthew R. Pearson** (University of New Mexico)

As cannabis legalization and product diversity expand, understanding the factors that drive or mitigate cannabis-related harms among young adults is paramount. This symposium integrates three distinct yet complementary perspectives—a pre-registered experiment, systematic review, and methodological innovation—to provide a comprehensive overview of the current landscape of cannabis science in college populations. The first presentation examines how cannabinoid content (THC vs. CBD) and route of administration (flower vs. edibles) influence health perceptions. Utilizing a large multisite experimental design, the results suggest that while CBD-dominant flower is viewed as relatively 'healthier,' young adults generally draw minimal distinctions between products based on potency, regardless of their underlying use motives. The second presentation provides a systematic review of cannabis protective behavioral strategies (PBS). By synthesizing nearly 60 studies, this talk identifies key antecedents of PBS use—ranging from personality traits to motives—and evaluates the evidence for PBS as a proximal mechanism of behavior change in harm reduction interventions. Finally, the third presentation addresses a critical measurement issue regarding the inaccuracy of self-report quantity estimates. Using qualitative coding of estimation methods, the authors demonstrate that the relationship between cannabis quantity and negative outcomes is significantly moderated by estimation precision, suggesting that the risk of quantity is only visible when measured accurately. Together, these presentations emphasize that reducing cannabis-related harm requires a nuanced understanding of how users perceive products, how they actively manage risk through protective behaviors, and how researchers can more accurately quantify use to predict cannabis-related outcomes.

PRESENTERS:

Perceived Effects of THC and CBD Content on Cannabis-Related Health Risks and Benefits: Exploring Motives and Use

Renee E. Magnan (Washington State University), **Benjamin O. Ladd** (Washington State University), **Matthew R. Pearson** (University of New Mexico), **Addictions Research Team**

A Systematic Review of the Use of Cannabis Protective Behavioral Strategies

Chloe E. Martinez (University of New Mexico), **Matthew R. Pearson** (University of New Mexico)

Does Estimation Method Moderate the Relationship between Cannabis Quantity and Cannabis-Related Outcomes

Mason L. Hatwan (University of New Mexico), **Matthew R. Pearson** (University of New Mexico), **Addictions Research Team**

Discussant: Matthew R. Pearson (University of New Mexico)

Friday, JULY 17, 2026

3:00 pm – 4:15 pm

Symposium *Alvarado F*

Cannabis Use Across the Lifespan: Epidemiology, Cognitive Vulnerability, and Brain-Behavior Function

Chair: **Godfrey D. Pearlson** (Yale University)

This symposium integrates epidemiological, neuro-cognitive, and complex behavioral imaging perspectives to examine the effects of cannabis use across the human lifespan. Despite evidence suggesting that different points across human adulthood may present differential benefits and risk profiles presentations from cannabis use, the majority of human cannabis research to date has focused on younger individuals. This lack is highlighted by the fact that increasing numbers of individuals in older age groups are using cannabis for both medical and recreational purposes, yet remain an understudied population. Symposium presentations span population-level analyses of cannabis use disorder and mental health symptoms stratified by age, experimental and observational studies of age-related cognitive vulnerability, and large-scale database investigations of cognitive aging. A final talk links cannabis-related impairment in simulated driving to functional MRI measures of brain activity, bridging neural mechanisms with real-world behavior. Together, these studies highlight how age moderates cannabis-related risk, following acute and chronic cannabis exposure, probing convergent evidence across levels of analysis and underscoring the need for lifespan-informed models of cannabis effects on brain and behavior.

PRESENTERS:

Effects of cannabis use on brain health across the lifespan

Anika M. Guha (University of Colorado Anschutz Medical Campus), **Zeining Fu** (Tri-institutional Center for Translational Research in Neuroimaging and Data Science; Georgia State University; Georgia Tech; Emory University), **Vince Calhoun** (TRENDS; Georgia State University; Georgia Tech; Emory University), **Kent E. Hutchison** (University of Colorado Anschutz Medical Campus)

Cannabis and cognition in the aging brain

Ashley Schnakenberg-Martin (Yale University), **Khaled Draghmeh** (Yale University), **Michael Stevens** (Yale University, IOL), **Godfrey Pearlson** (Yale University, IOL), **Deepak Cyril D'Souza** (Yale University)

Evaluating the prevalences of cannabis use disorder and mental health symptomatology in a U.S. nationally representative sample of adults, stratified by age
Lauren Pacek (Rutgers Institute for Nicotine and Tobacco Studies), **Julia Chen-Sankey** (Rutgers Institute for Nicotine and Tobacco Studies), **Meagan O Robichaud** (Rutgers Institute for Nicotine and Tobacco Studies), **Allison Glasser** (Rutgers Institute for Nicotine and Tobacco Studies)

Multivariate Associations Between Cannabis Induced Alterations in Global Brain Connectivity and Driving Performance: A Behavioral Partial Least Squares Analysis
Shashwath A. Meda (Olin Neuropsychiatry Res. Ctr, Institute of Living, Hartford Healthcare), **Michael C Stevens** (Yale University; Olin Neuropsychiatry Res. Ctr, Institute of Living, Hartford Healthcare), **Erwin Boer** (Entropy Control Inc), **Deepak Cyril D'Souza** (Yale University), **Cole Arnold** (Olin Neuropsychiatry Res. Ctr, Institute of Living, Hartford Healthcare), **Nique Pichette** (Olin Neuropsychiatry Res. Ctr, Institute of Living, Hartford Healthcare), **Godfrey D Pearlson** (Yale University; Olin Neuropsychiatry Res. Ctr, Institute of Living, Hartford Healthcare)

Discussant: Godfrey D. Pearlson (Yale University)

Friday, JULY 17, 2026

3:00 pm – 4:15 pm

Paper Session

Alvarado C

Highlighting the Research in *Cannabis*: Special Issue on Perinatal Cannabis Use

Chairs: **Eric R. Pedersen** (University of Southern California), **Lauren Micalizzi** (Brown University), **Rachel Gunn** (Brown University)

PRESENTERS:

Overview of the Cannabis Journal

Eric R. Pedersen (University of Southern California)

Introduction to the Special Issue on Perinatal Cannabis Use

Lauren Micalizzi (Brown University), **Rachel Gunn** (Brown University)

Cannabis Use During Early Pregnancy and Child Diagnoses of Depressive and Anxiety Disorders

Kelly C. Young-Wolff (Kaiser Permanente Northern California; University of California, San Francisco), **Bernard J. Tyson** (Kaiser Permanente School of Medicine)

Provider Perspectives of Conversations and Practices Surrounding Perinatal Cannabis Use

Marie A. Hayes (Medical University of South Carolina)

Intentions and Motives for Cannabis Use in Pregnancy and Postpartum: Preliminary Daily Diary Findings on Planned and Unplanned Use

Lindy K. Howe (Brown University)

Friday, JULY 17, 2026

4:15 pm – 5:15 pm

Alvarado AB

Poster Session I

(see pages 48 to 50 for details)

Light Snack Provided

6:30 – 11:00 pm

Friday Evening Social Event

**Outpost 1706 Bar, 301 Romero St NW Suite 205, Albuquerque,
NM 87104**

Please Join Us for a Happy Hour Social Event!

Appetizers are provided; drinks are available for purchase.

Saturday, JULY 18, 2026

8:00 am – 5:00 pm

Check-In/Registration

Outside Alvarado

8:00 am – 9:00 am

Continental Breakfast

Outside Alvarado

8:00 am – 9:00 am

Trainee Mentorship Breakfast

Alvarado AB

Are you a student, fellow, trainee, or someone else eager to learn about the diverse career paths available for people interested in researching cannabis? Or maybe you've begun your career journey and want personalized input and direction on where to go next? Look no further! This mentorship breakfast event provides a fantastic opportunity to connect with cannabis researchers across various career paths and other trainees in the cannabis field. Mentors will span different career stages and research settings (i.e., academia and industry). Come meet with mentors to have individualized discussions about how to navigate your career. Through informal conversations, you can learn about how to find, select, and be competitive for educational and fellowship opportunities; navigate academia; find or develop research opportunities; and much more! Don't miss out on this chance to shape your career journey from experts who have successfully navigated it. Bring your questions, curiosity, and excitement, and we'll take it from there. Coffee and continental breakfast will be provided.

PARTICIPATING MENTORS:

Kalina Fahey
Rachel Gunn
Cassidy LoParco
Godfrey Pearlson
Jamie Parnes
Charlie Villanueva

Saturday, JULY 18, 2026

9:00am – 10:15 am

Keynote Address

Alvarado D



Cross-National Marijuana Research and RSMj's Expansion

Adrian J. Bravo (William & Mary)

Dr. Adrian J. Bravo is an Associate Professor in the Department of Psychological Sciences at the College of William & Mary. He has a PhD in Applied Experimental Psychology from Old Dominion University. His research interests focus on identifying who is most susceptible to the development of substance use and mental health disorders, identifying under what conditions individuals engage in health risk behaviors that lead to poor mental health and problematic substance use, and identifying what factors may decouple (specifically mindfulness) the relation between health risk factors and health outcomes across distinct populations (i.e., college students, clinical populations, and military personnel). He is the Founder and Principal Investigator of the Cross-Cultural Addiction Study Team (CAST; founded in 2016), a collective of international scientists (18 investigators across 7 countries) in the behavioral sciences with a shared vision of answering meaningful research questions regarding addictive behaviors (predominately substance use) that have important global policy, prevention, and/or treatment implications. He is also the Founder and Principal Investigator of the Hispanic Addiction Research Team (HART; founded in 2023) which is a collective of scientists (12 researchers across 8 U.S. universities) in the behavioral sciences with a shared vision of answering meaningful research questions regarding addictive behaviors (predominately substance use) and mental health that have important global policy, prevention, and/or treatment implications within the U.S. Hispanic/Latino community. He has over 160 peer-reviewed publications in academic journals, serves as an Associate Editor on 3 peer-reviewed academic journals (Mindfulness, Cannabis, and Journal of Psychology and AI), and has several funded grants from the U.S. National Institute of Health, Spanish Ministry of Science, Innovation and Universities, and Argentina National Secretary of Science and Technology. Further, he is the current President of RSMj (which he co-founded in 2016).

10:15 am – 10:30 am

Break

Saturday, JULY 18, 2026

10:30 am – 11:45 am

Symposium

Alvarado D

Understanding Adolescent and Adult Cannabis Co-use with Alcohol and/or Nicotine: Integrating Experimental and EMA Findings

Chair: **Holly K. Boyle** (Yale University)

Co-use of cannabis with other psychoactive substances, particularly alcohol and nicotine, is increasingly common among adolescents and adults. This symposium presents four studies using laboratory and ecological momentary assessment (EMA) methods to examine patterns, predictors, and effects of cannabis co-use. The first presentation reports a laboratory experiment examining whether cannabis use influences cigarette puff choices under normal versus very low nicotine cigarette (VLNC) conditions among adolescents who smoke. Although cannabis use was associated with greater cigarette use, it did not influence the effectiveness of VLNC cigarettes for reducing cigarette choice. The second study presents a moderation analysis of a double-blind crossover trial (smoked THC vs. placebo) among adults, finding that observed alcohol-reducing effects of acute THC are attenuated by high baseline cannabis frequency and medical motives. Shifting to naturalistic settings, the third study used EMA to examine cannabis co-use with alcohol and/or nicotine among young adults. Compared with cannabis-only days, cannabis co-use with alcohol and/or nicotine was associated with more frequent cannabis use. Additionally, cannabis-nicotine co-use days were associated with greater likelihood of flower use, lower likelihood of edible use, and lower subjective 'high'. Lastly, the fourth study used EMA to assess whether cannabis acutely reduces alcohol craving among young adults. No evidence was found for cannabis' momentary impact on alcohol craving relative to non-use moments. However, examining cannabis use moments, a significant positive association between subjective cannabis 'high' and alcohol craving was identified. Together, these findings advance understanding of cannabis co-use and inform harm reduction and public health policy.

PRESENTERS:

Does marijuana use weaken the effect of reducing nicotine on choices to smoke in adolescents who smoke cigarettes?

Rachel N. Cassidy (Brown University), **Jennifer W. Tidey** (Brown University), **Mariel S. Bello** (University of South Carolina), **Eric Donny** (Wake Forest University), **Dorothy Hatsukami** (University of Minnesota), **Suzanne M. Colby** (Brown University)

Variability in cannabis use patterns modulates acute effects of THC on alcohol consumption

Lindy K. Howe (Brown University), **Rachel L. Gunn** (Brown University), **Jane Metrik** (Brown University)

Day-Level Cannabis Use Patterns and Perceived Intoxication During Alcohol and/or Nicotine Co-Use Among Young Adults

Holly K. Boyle (Yale School of Medicine), **Jennifer E. Merrill** (Brown University)

Cannabis use is associated with lower alcohol craving in the natural environment among young adults

Rachel L. Gunn (Brown University), **Lindy K. Howe** (Brown University), **Jane Metrik** (Brown University)



COLLABORATIVE
PERSPECTIVES on
ADDICTION



SAN DIEGO

April 28 - May 1, 2027

We hope to see you at the **15th annual CPA Conference** which will be held in **San Diego, CA** from **April 28 - May 1, 2027** at the **Hyatt Regency La Jolla**

For more information see: <https://addictionpsychology.org/cpa>

Saturday, JULY 18, 2026

10:30 am – 11:45 am

Symposium

Alvarado F

Exploring the Link Between Mental Health and Cannabis Use and Co-use in Young Adults: With Considerations for Clinical Practice

Chair: **Kyra Farrelly** (York University) & **Reagan Fitzke** (University of New Mexico)

Anxiety and stress-related disorders (e.g., posttraumatic stress disorder; PTSD) are highly prevalent and linked with problematic cannabis use and other risky behaviors, including polysubstance use. As rates of cannabis use are higher among individuals who report greater distress, it is critical to consider the relationships between anxiety/stress and cannabis-related consequences in high-risk populations, like young adults, and to consider the implications of this relationship in treatment for co-occurring disorders. This symposium integrates perspectives from the U.S. and Canada to consider anxiety/stress and related psychopathology as predictors of cannabis-use outcomes in young adults, including co-use with other substances, factors that may influence these relationships, and implications for clinical practice. Ms. Penta will use qualitative data to explore cannabis motives, related harms, and mental health factors among transgender and gender-diverse adults who co-use cannabis and alcohol. Ms. Farrelly will then discuss internalizing symptoms as a predictor for cannabis outcomes and co-use with other substances, examining how medicinal and recreational cannabis use can influence these relationships. Ms. Fitzke will extend this to consider how PTSD symptoms predict daily-level cannabis and polysubstance use, and the mediating role of mood. Ms. Carter will present a case study of a client with co-occurring Cannabis Use Disorder and Generalized Anxiety Disorder to discuss clinical relevance and treatment implications of the relationships explored across talks. This symposium will highlight the relationship between anxiety/stress with cannabis use and related consequences and can help illustrate the importance of competency to address both cannabis use and mental health in clinical practice.

PRESENTERS:

Cannabis Motives, Harms, and Mental Health Among Canadian Transgender and Gender Diverse Adults Who Co-use Cannabis and Alcohol: A Qualitative Study

Stephanie M. Penta (Toronto Metropolitan University), **Theo F. Quinn** (Toronto Metropolitan University), **Sarah S. Dermody** (Toronto Metropolitan University)

Internalizing Symptoms and Cannabis Use and Co-Use Outcomes among Young Adults: The Moderating Role of Medicinal Use

Kyra N. Farrelly (York University), **Keila A. Echakowitz** (Centre for Addiction and Mental Health), **Mahalia Dixon** (Centre for Addiction and Mental Health), **Matthew T. Keough** (York University), **Sergio Rueda** (Centre for Addiction and Mental Health), **Lena C. Quilty** (Centre for Addiction and Mental Health), **Sherry H. Stewart** (Dalhousie University), **Abby L. Goldstein** (University of Toronto) **James MacKillop** (McMaster University), **Jo Henderson** (Centre for Addiction and Mental Health), **Jeffrey D. Wardell** (York University; Centre for Addiction and Mental Health; University of Toronto)

Examining the role of affect in both PTSD symptoms and alcohol/cannabis co-use using momentary methods

Reagan E. Fitzke (University of New Mexico), **Lexi M. Sheffield** (University of New Mexico), **Lela Elliott** (University of New Mexico), **Colin T. Mahoney** (University of New Mexico), **Elizabeth A. Yeater** (University of New Mexico)

A Case Study on the Intersection of Heavy Cannabis Use and Severe Anxiety

Brenna A. Carter (Colorado State University). **Carolyn A. Lorenzi** (Colorado State University)

Discussant: Adrian J. Bravo (William & Mary)

Saturday, JULY 18, 2026

10:30 am – 11:45 am

Paper Session

Alvarado C

Neuroscience and Biomarker Research

Chair: **Ireland Shute** (University of Southern California)

PRESENTERS:

The role of subcortical brain tissue iron as an indicator of dopamine-related neurophysiology in adolescent cannabis use

Sarah A. Thomas (Alpert Medical School of Brown University; E.P. Bradley Hospital), **Meghan A. Gonsalves** (Brown University), **Gillian LeBlanc** (Brown University), **Elizabeth Lorenc** (Brown University), **Jane Metrik** (Brown University; Providence VA Medical Center), **Michael Frank** (Brown University), **Sarah Ryan** (E.P. Bradley Hospital), **Emily Olenik** (E.P. Bradley Hospital), **Leslie Brick** (University of New Mexico), **Anthony Spirito** (Alpert Medical School of Brown University), **Jodi Gilman** (Massachusetts General Hospital; Harvard Medical School)

Cannabis use is associated with blunted cortisol stress reactivity in individuals with early life stress and anxiety and trauma disorders

Leslie Brick (University of New Mexico), **Gemma T. Wallace** (Warren Alpert Medical School of Brown University; Butler Hospital), **Teresa E. Daniels** (Warren Alpert Medical School of Brown University; E.P. Bradley Hospital), **Asi P. Gobin** (Butler Hospital), **Zachary M. Harvanek** (Yale University; Connecticut Mental Health Center), **Stephanie H. Parade** (Warren Alpert Medical School of Brown University; E.P. Bradley Hospital), **Audrey R. Tyrka** (Warren Alpert Medical School of Brown University; Butler Hospital)

Detecting Cannabis Intoxication Using Wearable Biosensors and Machine Learning: A Pilot Study

Emma E. Smith (Colorado State University), **Eric E. Kaczora** (University at Buffalo, State University of New York), **Manohar Golleru** (University at Buffalo, State University of New York), **Mohammad I. Habib** (Colorado State University), **Kyle J. Kelleran** (University at Buffalo, State University of New York), **Bradley T. Conner** (Colorado State University)

11:45 am – 1:15 pm

LUNCH ON YOUR OWN

Saturday, JULY 18, 2026

1:15 pm – 2:30 pm

Symposium *Alvarado D*

Weeding Through the Complexities of the Cannabis Continuum Chair: **Elizabeth R. Aston** (Brown University)

Addiction is both a reality and a myth. Diagnostic labels, such as cannabis use disorder (CUD), offer valuable conceptual and biological shorthand for the behaviors and experiences of 'addiction,' but the etiology is inherently dynamic, unfolding over time with repeated drug exposures. Viewing CUD symptoms at a fixed point is helpful to triage preventative interventions and treatment, but the concept of a 'stable diagnosis' is a misnomer. This symposium stands on the shoulders of many others by seeking to describe the elusive concept of cannabis dependence, which is at once fluid and unchanging, and its development. This symposium will aim to weed through the complexities and map the cannabis continuum from its pre-exposure roots. Our speakers will illustrate how innate vulnerabilities meet environmental opportunity, ultimately demonstrating a multifaceted conceptualization of addiction. Dr. Aston will present results from work validating a novel behavioral economic purchase task for cannabis edibles among young adults; Dr. Smith-LeCavalier will present research characterizing the co-use phenotype of cannabis use and same-day alcohol consumption among adolescents; Dr. Sokolovsky will discuss daily correlates of CUD risk among young adults endorsing dual use of combustible and electronic cigarettes; and Dr. Micalizzi will present findings from a prospective study of susceptibility and risk for CUD progression using bioverified prenatal tobacco exposure. All presentations will discuss implications for the study of CUD, including its progression and maintenance. Dr. Treloar Padovano will synthesize these presentations and will comment on the complex and labile nature of CUD from gestation through young adulthood.

PRESENTERS:

Gimmie the gummies: Initial validation of the Edibles Marijuana Purchase task (eMPT) among young adults

Elizabeth R. Aston (Brown University), **Michael Amlung** (University of Kansas)

Characterizing the co-use phenotype of cannabis use and same-day alcohol consumption among adolescents

Kirstyn N. Smith-LeCavalier (Brown University), **Jane Metrik** (Brown University), **Jamie E. Parnes** (University of Massachusetts Amherst), **Hayley Treloar Padovano** (Brown University)

Daily-life behavioral correlates of CUDIT-R classifications of CUD risk among young adult dual users of combustible and electronic cigarettes

Alexander W. Sokolovsky (Brown University)

Bioverified prenatal tobacco exposure and adolescent cannabis use risk: A prospective study of susceptibility and risk progression

Lauren Micalizzi (Brown University), **Valerie S. Knopik** (Purdue University), **Kristina M. Jackson** (Rutgers University), **Kirby Deater-Deckard** (UMass Amherst), **Patricia M. Risica** (Brown University)

Discussant: Hayley Treloar Padovano (Brown University)

Saturday, JULY 18, 2026

1:15 pm – 2:30 pm

Symposium *Alvarado F*

'Weed Work Well Together': State Approaches to Cannabis Research and Regulation, Collaboration is Key

Chair: **Hailey Pensky** (Commonwealth of Massachusetts)

State enacted and implemented cannabis policies and programs have been constantly evolving since California first legalized for medical use in 1996. Since cannabis remains illegal at the federal level, research consistently falls behind law, leaving state-enacted policies and programs with many scientific unknowns. In fact, regulators often write policy in the absence of verified research and data, or ability to assess program effectiveness once implemented. Gaps in cannabis research and program effectiveness can contribute to major regulatory challenges and unknown research outcomes. As the science on cannabis accumulates and regulated programs evolve, it is critical that regulators and researchers alike understand effects of cannabis laws, policy provisions, and state-enacted programs (e.g., medical and social equity programs), ensuring evidence-based fidelity to programmatic missions and research alike. The goal of the 2026 RSMJ Regulation Research Panel is threefold: 1) Discuss varying applied cannabis regulatory research implemented across the U.S., 2) Show how states use conceptual frameworks and real-world data to assess patient outcomes, as well as effectiveness of medical and social equity programs, and lastly, 3) Provide space for researchers from academia to discuss research's role in cannabis regulation, and how these roles, traditionally siloed, can work together to ensure evidence-based cannabis policies in future. This panel brings regulator and academic researchers together to understand applied cannabis research at the intersection of changing cannabis policies, research, and state-enacted medical and social equity programs. Each panelist brings specialized knowledge in an area of policy in New York, Illinois, Maryland, and Massachusetts.

PRESENTERS:

Leveraging Real-World Data (RWD) to shape cannabis policy and future research design

Kaitlin Kosinski (New York State Office of Cannabis Management), **Sang Choi** (New York State Office of Cannabis Management), **Alexandria Wilkins** (New York State Office of Cannabis Management), **Junella Chin** (New York State Office of Cannabis Management), **Nakesha Abel** (New York State Office of Cannabis Management)

Barriers and Facilitators to Medical Cannabis in New York - Perspectives of Medical Cannabis Patients in New York State, Analysis of Three Cross-Sectional Surveys 2023-2025

Alexandria Wilkins (New York State Office of Cannabis Management), **Kaitlin Kosinski** (New York State Office of Cannabis Management), **Sang Choi** (New York State Office of Cannabis Management), **Junella Chin** (New York State Office of Cannabis Management), **Nakesha Abel** (New York State Office of Cannabis Management)

Pioneering Cannabis Social Equity: Results from Illinois 2025 Cannabis Diversity Survey

Nathaniel Inglis Steinfeld (Illinois Cannabis Regulation Oversight Office), **Kirsten Davis-Franklin** (Illinois Cannabis Regulation Oversight Office), **Erin Johnson** (Illinois Cannabis

Regulation Oversight Office), **Joseph Alger** (Illinois Cannabis Regulation Oversight Office), **Lance King** (University of Illinois), **Justin Leiby** (University of Illinois)

Cannabis Social Equity as a Structural Determinant of Health: A Maryland Implementation Framework

Audrey Johnson (Maryland Office of Social Equity)

Discussant: Hailey Pensky (Commonwealth of Massachusetts)

Saturday, JULY 18, 2026

1:15 pm – 2:30 pm

Paper Session

Alvarado C

Cannabis Policy/Regulation/Marketing #2

Chair: **Stephanie Penta** (Toronto Metropolitan University)

PRESENTERS:

Recall of cannabis advertising messages and warnings among US young adults: An experimental study

Cassidy R. LoParco (George Washington University), **Yuxian Cui** (George Washington University), **Morgan B. Speer** (George Washington University), **Darcey M. McCreedy** (George Washington University), **Sadie Harper** (Brescia University), **Patricia A. Cavazos-Rehg** (Washington University St. Louis), **Carla J. Berg** (George Washington University)

Health Halo and Horn Effects on Cannabis Edible Packaging

Emma J. Therkildsen (Washington State University), **Renee E. Magnan** (Washington State University)

Characteristics of cannabis warnings in the United States: A content analysis

Sarah D. Kowitt (UNC Chapel Hill), **Rachel Callanan** (Public Health Law Center), **Luke Haqq** (Public Health Law Center), **Kristen L. Jarman** (UNC Chapel Hill), **Sonia A. Clark** (UNC Chapel Hill), **Gillian L. Schauer** (Cannabis Regulators Association), **Julia A. Dilley** (Multnomah County Health Department and Oregon Public Health Division), **Leah M. Ranney** (UNC Chapel Hill)

Inside the regulatory process of developing and implementing cannabis product warnings: A qualitative study

Leah M. Ranney (University of North Carolina at Chapel Hill), **Sonia A. Clark** (University of North Carolina at Chapel Hill), **Megan J. Faber** (University of North Carolina at chapel Hill), **Tyler West** (University of North Carolina at Chapel Hill), **Christopher Bosley** (University of North Carolina at Chapel Hill), **Kristen L. Jarman** (University of North Carolina at Chapel Hill), **Gillian L. Schauer** (University of Washington) **Julia A. Dilley** (Multnomah County Health Department and Oregon Public Health Division), **Sarah D. Kowitt** (University of North Carolina at Chapel Hill)

2:30 pm – 2:45 pm Break

Saturday, JULY 18, 2026

2:45 pm – 4:00 pm

Symposium

Alvarado D

The PBSM 10 Years Later: Advancing Cannabis Protective Behavioral Strategy Measurement Across Populations and into the Modern Cannabis Landscape

Chair: **Eric R. Pedersen** (University of Southern California)

Protective behavioral strategies (PBS) are harm-reduction behaviors individuals use before, during, or after substance use to reduce risk. The Protective Behavioral Strategies for Marijuana Scale (PBSM) was developed a decade ago to assess cannabis-specific strategies associated with lower use and fewer negative consequences. Since its introduction, the PBSM has become a widely used measure of cannabis protective strategies, with several versions including the original item pool, a 36-item item bank, and a commonly used 17-item short form. This symposium provides a 10-year update on the PBSM and examines how the measure can be adapted for emerging populations within a changing cannabis landscape. Eric Pedersen opens with an overview of the development of the PBSM, including item generation, psychometric refinement, and evidence supporting its use across studies of cannabis use and consequences. Two presentations then examine adaptations for specific populations. Keegan Buch evaluates the dimensional structure of the 17-item PBSM among sexual minority college students, identifying a four-factor structure that may reflect unique safety considerations and motivations for protective strategy use among this group. Kristina Phillips introduces the PBSM-O, a revised version for adults aged 50 and older who use cannabis, demonstrating a four-factor structure capturing controlled use, mindful use, contextual responsibility, and situational safety. Mark Prince then presents ongoing work to update the PBSM through development of the Protective Behavioral Strategies for Cannabis (PBSC) scale, designed to reflect contemporary cannabis products and modes of administration. The symposium concludes with discussion of future research directions and opportunities for collaboration.

PRESENTERS:

Dimensional Structure of the Protective Behavioral Strategies for Marijuana Scale among Sexual Minority College Students

Keegan D. Buch (San Diego State University/UC San Diego), **Mark A. Prince** (University of Southern California), **Ireland M. Shute** (University of Southern California), **Reagan E. Fitzke** (University of New Mexico), **Megan E. Brown** (University of Colorado Boulder), **Eric R. Pedersen** (University of Southern California)

One Size Doesn't Fit All: Adapting the PBSM for Adults Over Age 50 Who Use Cannabis

Kristina T. Phillips (Kaiser Permanente Hawaii Center for Integrated Health Care Research; Kaiser Permanente Bernard J. Tyson School of Medicine), **Mark A. Prince** (University of Southern California), **Eric R. Pedersen** (University of Southern California)

Updating Protective Behavioral Strategies for Marijuana Scale for the Modern Cannabis Landscape: Development of the PBSC Scale

Mark A. Prince (University of Southern California), **Denise D. Tran** (University of Southern California), **Bethany A. Gray** (Colorado State University), **Ireland M. Shute** (University of Southern California), **Eric R. Pedersen** (University of Southern California)

Saturday, JULY 18, 2026

2:45 pm – 4:00 pm

Panel Discussion

Alvarado F

Driving Human Subjects Research in a State of Change: Measurement, Recruitment, and Ethical Lessons Learned in a Cannabis and Open-Road Driving Performance Protocol

Chair: **Nicole Ennis** (Florida State University)

Conducting human subjects research on cannabis in Florida presents a unique set of challenges shaped by legal, regulatory, and social factors. This panel discussion will focus on lessons learned in implementation through measurement, recruitment, and regulatory processes. Specifically, we will: 1) describe the sample (N=40 to date) and discuss measurement of cannabis and driving performance; 2) examine current recruitment challenges, engagement of community partners and the impact of the changing legal landscape on qualified medical marijuana physicians; and 3) discuss the regulatory and ethical hurdles of this work and describe impactful solutions. In addition, we will examine how risk-benefit analyses were conducted in the context of studying real-world driving performance and how privacy protections were implemented to safeguard sensitive information related to cannabis use. The discussion will highlight practical solutions and lessons learned that may inform future cannabis research conducted in similarly complex regulatory environments.

PRESENTERS:

Quantifying Cannabis: Improving measurement strategies through data triangulation

Nicole Ennis (Florida State University), **Sherrilene Classen** (University of Florida), **Yuxia Wang** (Florida State University), **John Markowitz** (University of Florida), **Michael Killian** (Florida State University), **Jason Rogers** (University of Florida)

The practical challenges of recruitment: Managing recruitment roadblocks

Katie Kloss (Florida State University), **Bianca Jean Philippe** (Florida State University), **Sara Green** (Florida State University), **Nicole Ennis** (Florida State University)

Ethical and Regulatory Lessons Learned from Implementing a Cannabis and Driving Performance Protocol

Sara Green (Florida State University), **Katie Kloss** (Florida State University), **Sherrilene Classen** (University of Florida) **Nicole Ennis** (Florida State University)

Saturday, JULY 18, 2026

2:45 pm – 4:00 pm

Paper Session

Alvarado C

Community and Patient-Oriented Research

Chair: **Kyra Farrelly** (York University)

PRESENTERS:

Are You an Asshole for Smoking? Cannabis Norms Related to Neighbor Disputes, Public Use, and Narcing

Matt Reid (Widener University)

Patient-Reported Patterns of Cannabis Consumption and Subjective Effects in Rheumatic and Musculoskeletal Diseases

Joanna S. Zeiger (Canna Research Foundation), **Patti Katz** (University of California), **Kaleb Michaud** (University of Nebraska)

Cannabis use among US young adult cancer survivors: impacts of legal context, information sources, and interactions with healthcare providers

Darcey M. McCready (George Washington University), **Laura C. Schubel** (George Washington University, MedStar Health Research Institute), **Darby Mihelich** (George Washington University), **Miranda Johnson** (George Washington University), **Cassidy R. LoParco** (George Washington University), **Hannah Arem** (MedStar Health Research Institute), **Carla J. Berg** (George Washington University)

Perspectives on Cannabis Among Native American Patients Seeking Pain Management

Sara Mills (Washington State University), **Katrina Iiams-Hauser** (Qwibil Clinic), **Marian Wilson** (Washington State University), **Crystal Smith** (Washington State University), **Ross Bindler** (Washington State University), **Michael McDonell** (Washington State University), **Naomi Bender** (Spokane Colleges), **Selena Eon** (Qwibil Clinic)

4:00 pm – 5:00 pm

Poster Session II

(see pages 45 to 48 for details)

Alvarado AB

Light snack provided

Sunday, JULY 19, 2026

8:00 am – 12:00 pm Check-In/Registration
Outside Alvarado

8:00 am – 9:00 am Continental Breakfast
Outside Alvarado

9:00 am – 10:15 am Symposium
Alvarado D

Derived Intoxicating Cannabis Products: An Overview of Retail, Marketing, Perceptions, and Use Behaviors

Chair: **Dan Petrovitch** (Texas Tech University; The University of Texas Health Science Center at Houston)

This symposium utilizes a Socioecological Model perspective to integrate retail, marketing, and individual-level epidemiological data on derived intoxicating cannabis products (DICPs), federally illegal substances that have been increasing in retail sales and use in the US. The first presentation, by Dr. Cassidy LoParco, provides an overview of retail availability of DICPs from point-of-sale audits across smoke shops (N = 126 smoke shops) in 9 US cities. The second presentation, by Dr. Julia Chen-Sankey, describes retailer marketing practices used by 9 leading DICI brands on their Instagram accounts (N = 837 posts). The third presentation, by Dan Petrovitch, uses data from an online survey among a convenience sample (N = 1,189) of US adults to examine differences between 'traditional' cannabis and DICI risk perceptions and motives. Lastly, the presentation by Dr. Carla Berg utilizes survey data among a national sample of young adults (N = 3,437) to examine correlates of medical and non-medical use of cannabis and DICPs. Findings across studies indicate the widespread prevalence of DICI retail, marketing, and use. Cross-study findings reveal convergence across levels of analysis: point-of-sale and social media marketing both featured youth-oriented materials, individual-level product preferences aligned with observed retail characteristics, and medical-use motives were prevalent across samples yet only modestly reflected in online advertising content. Youth-oriented marketing and lack of age verification procedures indicate the need for continued surveillance of DICPs and greater enforcement of DICI laws for harm reduction purposes.

PRESENTERS:

Smoke shops' marketing practices and retail of intoxicating substances: A 2025 point-of-sale audit in 9 US cities

Cassidy R. LoParco (George Washington University), **Matthew E. Rossheim** (The University of North Texas Health Science Center), **Kayla K. Tillett** (The University of North Texas Health Science Center), **Patricia A. Cavazos-Rehg** (Washington University School of Medicine), **Carla J. Berg** (George Washington University; George Washington Cancer Center)

Marketing Features of Derived Intoxicating Cannabis Product Brands on Instagram: A Content Analysis

Kathryn La Capria (Rutgers Institute for Nicotine & Tobacco Studies), **Siyan Meng** (Rutgers Institute for Nicotine & Tobacco Studies; Rutgers School of Public Health), **Alisa A. Padon** (Public Health Institute), **Kayla K. Tillett** (University of North Texas Health Science Center), **Scott I. Donaldson** (Rutgers Institute for Nicotine & Tobacco Studies; Rutgers Robert Wood Johnson

Medical School), **Jon-Patrick Allem** (Rutgers Institute for Nicotine & Tobacco Studies; Rutgers School of Public Health; Rutgers Robert Wood Johnson Medical School), **Matthew E. Rossheim** (University of North Texas Health Science Center), **Cassidy LoParco** (George Washington University), **Carla J. Berg** (George Washington University; George Washington Cancer Center), **Kristina M. Jackson** (Rutgers Robert Wood Johnson Medical School; Rutgers Addiction Research Center), **Julia Chen-Sankey** (Rutgers Institute for Nicotine & Tobacco Studies; Rutgers School of Public Health)

Risk Perceptions and Motives for Cannabis and Derived Intoxicating Cannabis Products: A Cross-Sectional Survey in a Non-Probability Sample of Co-Using U.S. Adults

Dan Petrovitch (Texas Tech University; University of Texas Health Science Center at Houston), **Sarah E. Victor** (Texas Tech University), **Adam T. Schmidt** (Texas Tech University), **Jason Van Allen** (Texas Tech University), **Andrew K. Littlefield** (Texas Tech University)

Medical use of cannabis and derived intoxicating cannabis products in a sample of young adults in the US

Darcey McCready (George Washington University; George Washington Cancer Center), **Laura C. Schubel** (George Washington University), **Cassidy R. LoParco** (George Washington University), **Shriya Thakkar** (George Washington University), **Morgan Speer** (George Washington University), **Yuxian Cui** (George Washington University), **Xiao Li** (Washington University School of Medicine), **Patricia A. Cavazos-Rehg** (Washington University School of Medicine), **Carla J Berg** (George Washington University)

Discussant: Dan Petrovitch (Texas Tech University; The University of Texas Health Science Center at Houston)

10:15 am – 10:30 am

Break

Sunday, JULY 19, 2026

10:30 am – 11:45 am

Paper Session

Alvarado D

Cannabis Policy/Regulation/Marketing #3

Chair: **Mohammad Habib** (Colorado State University)

PRESENTERS:

Driving by frequent cannabis users 'the morning after' last use of smoked cannabis: Relationship to THC

Christina Zakala (Centre for Addiction and Mental Health), **Sampson Zhao** (Centre for Addiction and Mental Health), **Alex Battistuzzi** (Centre for Addiction and Mental Health), **Adrien Nette** (Centre for Addiction and Mental Health), **Justin Matheson** (Centre for Addiction and Mental Health), **Bernard Le Foll** (Centre for Addiction and Mental Health), **Christine M. Wickens** (Centre for Addiction and Mental Health), **Pamela Kaduri** (Centre for Addiction and Mental Health), **Omer Hasan** (Centre for Addiction and Mental Health), **Wei Wang** (Centre for Addiction and Mental Health), **Sheng Chen** (Centre for Addiction and Mental Health)

Understanding How Leading Cannabis Brands Use 'Natural,' 'Clean,' 'Pure,' and 'Organic' Claims in Their Marketing

Julia Chen-Sankey (Rutgers Institute for Nicotine and Tobacco Research), **Kathryn La Capria** (Rutgers Institute for Nicotine and Tobacco Research), **Julianna Garvey** (Rutgers University), **Jayvaria Butt** (Rutgers University), **Leila Koster** (Rutgers University)

Association between neighborhood deprivation, distance, and compliance with a state ban on sales to apparently alcohol-intoxicated customers by adult-use cannabis and alcohol retailers

David B. Buller (Klein Buendel, Inc.), **W. Gill Woodall** (Klein Buendel, Inc.), **Robert Saltz** (Prevention Research Center), **James C. Fell** (James C Fell Consulting LLC), **Noah Chirico** (Klein Buendel, Inc.), **Gary R. Cutter** (University of Alabama at Birmingham), **Ian D. Buller** (DLH, LLC), **Lila Martinez** (Klein Buendel, Inc.), **Amanda N. Brice** (Klein Buendel, Inc.)

Association between legal access to cannabis and rates of suicide mortality among adults in the United States from 2012 to 2023

Mengni Jing (University of Michigan), **Spruha Joshi** (University of Michigan)

11:45 am – 12:00 pm

Concluding Remarks

Alvarado D

Jane Metrik (Brown University)

POSTER SESSION I: ALVARADO AB

FRIDAY, JULY 17, 2026, 4:15 PM – 5:15 PM

Posters are to be displayed on the board that corresponds to the number of your poster. You can put your poster up any time during the day on Fri. by 4:15 pm. Please remove your poster at 5:15 p.m.

1. **Perceived potency and THC vaping behavior in young adults: an Ecological Momentary Assessment study**
Michael S. Dunbar (RAND), Graham T. DiGiuseppi (RAND), Claude M. Setodji (RAND), Rachana Seelam (RAND), Anthony Rodriguez (RAND), Peyton Miller (RAND), Elizabeth J. D'Amico (RAND)
2. **Cannabis and Psilocybin Co-use: Associations with Stress and Well-being**
Alexia Obrochta (Oregon State University), Anita Cservenka (Oregon State University)
3. **Motives for Use, Background Mood, and Experienced Mood Effects of Cannabis Use Among Young Adults**
Veronica M. Bucci (University of Illinois Chicago), Robin J. Mermelstein (University of Illinois Chicago)
4. **Retail availability of THC and mushroom products across eleven cities: Differences by state laws**
Cassidy R. LoParco (George Washington University), Matthew E. Rossheim (University of North Texas Health Science Center), Kayla K. Tillett (University of North Texas Health Science Center), Yuxian Cui (George Washington University), Miranda Johnson (George Washington University), Morgan Speer (George Washington University), Darby Mihelich (George Washington University), Hermela Amdeta (George Washington University), Diane Ndisebuye (George Washington University), Carla J. Berg (George Washington University)
5. **THC Beverages Sold by Online Alcohol Retailers**
Cassidy R. LoParco (George Washington University), Kayla K. Tillett (University of North Texas Health Science Center), Matthew E. Rossheim (University of North Texas Health Science Center), Carla J. Berg (George Washington University)
6. **Evaluating the accuracy of cannabis quantity estimations**
Mohammad I. Habib (Colorado State University), Brad T. Conner (Colorado State University)
7. **Predicting Cannabis Use from Cannabis Demand using Ecological Momentary Assessment with Midwestern Community Adults**
Brandon P. Miller (University of Kansas), Noah N. Emery (Colorado State University), Michael Amlung (Cofrin Logan Center for Addiction Research and Treatment; University of Kansas)
8. **Sensation Seeking, Impulsivity, and Risky Sexual Behavior Among Inpatient Youth: The Moderating Role of Morning Cannabis Use**
Carolyn A. Lorenzi (Colorado State University), Mohammad I. Habib (Colorado State University), Jesse D. Hinckley (University of Colorado Anschutz), Bradley T. Conner (Colorado State University)

9. **Characterizing Cannabis Use Among Recently Trauma-Exposed Emergency Department Patients**
Gillian Rossmann (Brown University; Rhode Island Hospital), Gabi Prieto (Brown University; Rhode Island Hospital), Chelsie Benca-Bachman (Brown University), Nicole R. Nugent (Brown University; Rhode Island Hospital), Leslie A. Brick (University of New Mexico; Brown University)
10. **Healthcare distrust and cannabis and alcohol use by age cohorts: Evidence from HINTS**
Jessica A. Kulak (University at Buffalo), Bethea A. Kleykamp (University of Maryland), Nicholas J. Felicione (University at Buffalo)
11. **2025 Survey of New Mexico Cannabis Consumers: Findings from Registered Medical Cannabis Patients**
Ismail Zoutat (State of New Mexico Department of Health), Dominick Zurlo (State of New Mexico Department of Health), Rosalie Nava (State of New Mexico Department of Health), Carman Batista (State of New Mexico Department of Health), Adrian Estrada (State of New Mexico Department of Health), Katy Freytag (State of New Mexico Department of Health)
12. **Usage of and Adverse Reactions to Traditional Cannabis and Intoxicating Hemp-Derived Products Among Kentucky College Students**
Alejandro B. Ramirez (Western Kentucky University), Jenni B. Teeters (Western Kentucky University), Nathan D. Meredith (Western Kentucky University)
13. **Distinguishing medical from nonmedical cannabis use among US young adult cancer survivors**
Darcey M. McCready (George Washington University), Laura C. Schubel (George Washington University; MedStar Health Research Institute), Hermela Amdeta (George Washington University), Diane Ndisbuye (George Washington University), Cassidy R. LoParco (George Washington University), Hannah Arem (MedStar Health Research Institute), Carla J. Berg (George Washington University)
14. **Cannabis Involvement and Suicidal Ideation: Examining the Utility of the Integrated Motivational-Volitional Model of Suicide**
Nathan D. Meredith (Western Kentucky University), Alejandro B. Ramirez (Western Kentucky University), Jenni B. Teeters (Western Kentucky University)
15. **Exploring Associations between Cannabis Use and Suicidality in Emerging Adults: A Scoping Review**
Nathan D. Meredith (Western Kentucky University), Alejandro B. Ramirez (Western Kentucky University), Jenni B. Teeters (Western Kentucky University)
16. **Beliefs and informational influences contributing to medical cannabis (MC) use between established and new MC users in Florida**
Kendall R Robinson (University of Florida), Robert L Cook (University of Florida), Yan Wang (University of Florida)
17. **Exploration of the Relationship Between Cannabis and Incentive-Sensitization**
Ethan T.B. (Colorado State University), Emma Smith (Colorado State University), Mohammad I. Habib (Colorado State University), Bradley T. Conner (Colorado State University)

18. **Cannabis Use Associated with Emergent Behavioral Tasks and Risky Behavior**
Samuel M. DiCecco (University of Minnesota; Colorado State University), Bradley T. Conner (Colorado State University)
19. **Exposure to information about cannabis health risks among adults in the United States**
Sarah D. Kowitt (UNC Chapel Hill), Isabelle Duguid (UNC Chapel Hill), Kristen L. Jarman (UNC Chapel Hill), Leah M. Ranney (UNC Chapel Hill), Jennifer Cornacchione Ross (Boston University)
20. **Social Support and Coping Self-Efficacy among Women Intimate Partner Violence Survivors engaging in Cannabis and Alcohol Co-use**
Elisabeth C. McLane (University of Colorado), Brigitta M. Beck (University of Colorado), Reagan E. Fitzke (The University of New Mexico), Nicole A. Barbaro (The University of New Mexico), Colin T. Mahoney (The University of New Mexico & Center on Alcohol, Substance use, And Addictions)
21. **In the high of the budholder: Assessing subjective cannabis potency associations in adolescents and young adults using timeline followback**
Jamie E. Parnes (University of Massachusetts Amherst), Ryan W. Carpenter (University of Notre Dame), Kristin Rogers (Brown University), Robert Miranda Jr. (Brown University)
22. **Examining Cannabis Use as a Moderator of Depressive Symptoms and Pain Experiences in Young Adults with Chronic Pain**
Julia Donner (Washington State University), Benjamin Ladd (Washington State University), Jessica Fales (Washington State University), Renee Magnan (Washington State University)
23. **Green Corridors: A County and Municipality Level Assessment of Adult Use and Medical Dispensary Density in Massachusetts**
Alexander M. Colby (Cannabis Control Commission of Massachusetts), Graelyn Humiston (Cannabis Control Commission of Massachusetts), Victoria Jean Louis (Cannabis Control Commission of Massachusetts), Julie K. Johnson (Cannabis Control Commission of Massachusetts)
24. **Associations between past year psilocybin use, cannabis use frequency, and cannabis use disorder among college students**
Jayden Mather (Colorado State University), Cassandra Richardson (Colorado State University), Emma Thompson (Colorado State University), Rachel Longridge (Colorado State University), Noah Emery (Colorado State University)
25. **Associations of Cannabis Use with Current Tobacco Use among US Veterans: Findings from Wave 7 of the Population Assessment of Tobacco and Health Study**
Rachel Sayko Adams (Boston University), Melissa Little (University of Virginia), Connor Buchholz (Boston University), Rime Jebai (Boston University), Lysie R. Ranker (Boston University), Anthony J. Rosellini (Boston University), Joshua Gray (Uniformed Services University), Jennifer Cornacchione Ross (Boston University)
26. **Relations Between Anxiety Sensitivity, Impulsive Traits, and Cannabis Consequences**
Michael J. Erickson (Arizona State University), Jack T. Waddell (Arizona State University)

27. 'Growing Up in the Hempire': Using ICPS Data to Contextualize Youth Novel Cannabinoid Use in Massachusetts

Alexander M. Colby, (Cannabis Control Commission of Massachusetts), Graelyn Humiston (Cannabis Control Commission of Massachusetts), Victoria Jean Louis (Cannabis Control Commission of Massachusetts), Julie K. Johnson (Cannabis Control Commission of Massachusetts)

POSTER SESSION II: ALVARADO AB

SATURDAY, JULY 18, 2026, 4:00 PM – 5:00 PM

Posters are to be displayed on the board that corresponds to the number of your poster. You can put your poster up any time during the day on Sat. by 4:00 pm. Please remove your poster at 5:00 pm.

1. Cannabis use changes self-reported stress among college students with Cannabis Use Disorder: An ecological momentary assessment
Cassandra Richardson (Colorado State University), Jayden Mather (Colorado State University), Noah N. Emery (Colorado State University)
2. Cannabis Use Eating Experiences and Use Disorder Symptoms Among University Students Who Engage in Binge Eating and Heavy Episodic Drinking
Ireland Shute (Keck School of Medicine of USC), Neil Gleason (Keck School of Medicine of USC), Grace Eamer (Keck School of Medicine of USC), Mark A. Prince (Keck School of Medicine of USC), Eric R. Pedersen (Keck School of Medicine of USC)
3. Differences in Cannabis Use Problems, Consequences, and Protective Behavioral Strategies Based on Gender Conformity
Kalina M. L. Fahey (CASAA; University of New Mexico), Lucien Gil Rey (University of New Mexico), Christina Gillezeau (University of New Mexico), Margo C. Villarosa-Hurlocker (CASAA; University of New Mexico)
4. Treatment Efficacy of Cannabis and Cannabinoids for Symptoms of Autism Spectrum Disorder: A Meta-Analysis of Validated Outcomes
Alexandra Arnett (California State University), Chris Miller (California State University), Ellen Woo (California State University), Dawson Hedges (BYU)
5. Exploring cannabis problem severity as a moderator of cannabinoid potency on perceived health effects and likelihood to use
Benjamin Ladd (Washington State University Vancouver), Renee Magnan (Washington State University Vancouver), Beatrice Caffé (Washington State University)
6. Impulsive Personality Traits Predict, Use Frequency, and Cannabis Effects
Scott P. Root (Arizona State University), Nadia Kim (Arizona State University), Jack T. Waddell (Arizona State University)
7. Spirituality and Cannabis Use among U.S. College Students: Exploring Spiritual Cannabis Use Motives, Compatibility, and Benefit
Kira L. Sturgess (William & Mary), Adrian J. Bravo (William & Mary)

8. **Negative Affect Relates More to Subjective Cannabis Outcomes Than Objective Use: A Cross-Sectional Replication**
Emily C. Barnard (Suffolk University; Boston Medical Center), Brianna R. Altman (Rutgers, The State University of New Jersey), Maha N. Mian (Suffolk University; University of California), Mitch Earleywine (University at Albany, SUNY)
9. **CBD Advertisements: Differences in CBD Appeal, Perceived Product Safety and Perceptions of Prohibited Claims Among CBD Users and Never Users**
Kimberly Wagoner (Wake Forest University School of Medicine), Cindy Suerken (Wake Forest University School of Medicine), Beth Reboussin (Wake Forest University School of Medicine), Olivia Horton (Wake Forest University School of Medicine), Edgar Alfonso Romero-Sandoval (Wake Forest University School of Medicine), Allison J. Lazard (University of North Carolina at Chapel Hill), Kerry Cork (Public Health Law Center)
10. **Randomized Controlled Trial to Assess the Impact of CBD Advertising on CBD Product Purchase**
Kimberly Wagoner (Wake Forest University School of Medicine), Cindy Suerken (Wake Forest University School of Medicine), Beth Reboussin (Wake Forest University School of Medicine), Marissa Hall (University of North Carolina at Chapel Hill), Allison J. Lazard (University of North Carolina at Chapel Hill), Olivia Horton (Wake Forest University School of Medicine), Kerry Cork (Public Health Law Center), Edgar Alfonso Romero-Sandoval (Wake Forest University School of Medicine), Kathleen Egan (Wake Forest University School of Medicine), Amber Jones (Wake Forest University School of Medicine)
11. **Acculturative Stress, Coping Motives, and Cannabis Use Among Latino College Students**
Hanna Pazo Vargas (William & Mary), Adrian J. Bravo (William & Mary)
12. **Perceived Meaning of Naturalness-Related Marketing Descriptors on Cannabis Vape Product Packaging Among U.S. Adults**
Julia Chen-Sankey (Rutgers University), Marisa Tomaino (Rutgers University), Kathryn La Capria (Rutgers University), Michelle Bover Manderski (Rutgers University)
13. **Marijuana and alcohol use in high school as predictors of mental and cognitive health 40 years later using data from the NLSY79**
María Eugenia Contreras-Pérez (Rutgers University), Eric F. Wagner (Florida International University)
14. **Path Analysis of Alcohol, Cannabis, and Simultaneous Co-Use Frequency on Positive and Negative Consequence Severity**
Eleftherios M. Hetelekides (Colorado State University), Brenna Carter (Colorado State University), Mark A. Prince (Keck School of Medicine), Hollis C. Karoly (University of Colorado Anschutz Medical Campus), Bradley T. Conner (Colorado State University)
15. **Day-Level Associations Between Cannabis Use and Sleep During Pregnancy**
Ami S. Ikeda (Brown University), Lindy K. Howe (Brown University), Alexander W. Sokolovsky (Brown University), Jane Metrik (Brown University; Providence Veterans Affairs Medical Center), Cynthia Battle (Brown University), Lauren Micalizzi (Brown University), Rachel L. Gunn (Brown University)

16. **Beyond Exposure: The Role of Self-Reported Trauma Severity in Cannabis Use Disorder Risk**
Megan E. Brown (University of Colorado Boulder), Cassidy Mora (University of Colorado Boulder), Jonathon K. Lisano (University of Colorado Boulder), L. Cinnamon Bidwell (University of Colorado Boulder)
17. **Cannabis Use Among Autistic Adolescents and Young Adults: Differences by Timing of ASD Diagnosis**
María Eugenia Contreras-Pérez (Rutgers University), Lauren Micalizzi (Brown University), Xiangyu Tao (Rutgers University), Stephen J. Sheinkopf (University of Missouri), Anthony Spirito (Brown University), Kristina M. Jackson (Rutgers University)
18. **Alcohol Use, Cannabis Expectancies, and Cannabis Use Among Women with and Without Anxiety Disorders**
Karina Villalba (University of Central Florida), Jennifer Attonito (Florida Atlantic University)
19. **Everyday Discrimination, Insomnia Symptoms, and Cannabis Use**
Maria M. Wong (Idaho State University), Matthew R. Pearson (Center on Alcohol, Substance Use, and Addictions, University of New Mexico), Addiction Research Team (Center on Alcohol, Substance Use, and Addictions, University of New Mexico)
20. **Comprehensive Evaluation of Cannabis Use Patterns among College Students**
James M. Henson (Old Dominion University), Matthew R. Pearson (University of New Mexico), Addictions Research Team
21. **Buffering Against Risk: Cannabis Protective Behavioral Strategies as a Moderator of the Relationship between Psychosocial Risk Factors and Cannabis-Related Outcomes**
Zurial A. Lamour (University of New Mexico), Joey C. Mok (University of New Mexico), Matthew R. Pearson (University of New Mexico), Addictions Research Team
22. **Cannabis Protective Behavioral Strategies as a Proximal Mediator of the Relationship Between Psychosocial Risk Factors and Cannabis-Related Outcomes**
Vanessa C. Hernandez (University of New Mexico), Chloe E. Martinez (University of New Mexico), Matthew R. Pearson (University of New Mexico), Addictions Research Team
23. **Competing Measurement Models for the Measurement of Cannabis Protective Behavioral Strategies**
Kaelyn G. Gieske (University of New Mexico), Joey C. Mok (University of New Mexico), Matthew R. Pearson (University of New Mexico), Addictions Research Team
24. **Identifying High-Impact Cannabis Protective Behavioral Strategies Using Machine Learning**
Kaviya Thiyagarajan (University of New Mexico), Jenny L. Nguyen (University of New Mexico), Matthew R. Pearson (University of New Mexico), Addictions Research Team
25. **Co-Use of Commercial Tobacco and Cannabis in American Indian Young Adults**
Karla D. Llanes (University of Texas at El Paso), Prescilla Cobian (University of Southern California), Justin Boogaard (University of Southern California), Pamela M. Ling (University of California San Francisco), Kimberly Koester (University of California San Francisco), Sabrina Islam (University of California San Francisco), Guadalupe G. Ramos (University of Southern California), Sarah Keller (University of Southern California), Claradina Soto (University of Southern California)



EDITOR

Eric R. Pedersen

ASSOCIATE EDITORS

Adrian Bravo

Anita Cservenka

Julie Johnson

Jamie Parnes

Mark Prince

MANAGING EDITOR

Ireland Shute

Cannabis

Publication of the Research Society on Marijuana

Submit your work to Cannabis here: <https://www.researchmj.org/journal>